

# 17.5/24kV Deadbreak 250A Straight Connector

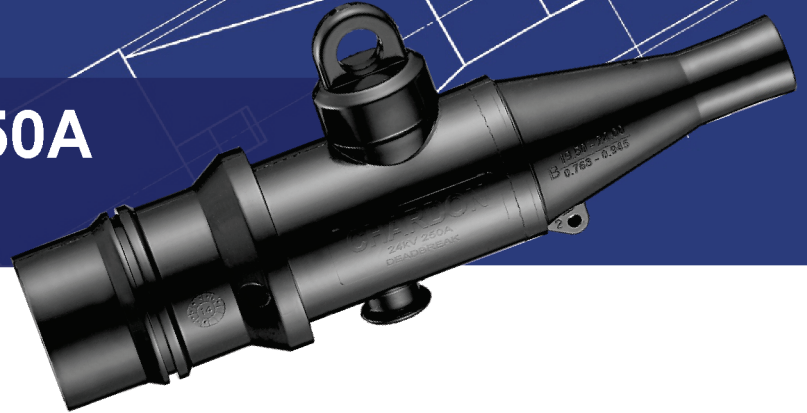

## Application

The Chardon Deadbreak Straight Connector is a fully shielded and insulated termination for connecting underground cable to transformers, switch gear and other apparatus equipped with deadbreak bushings, junctions, or other deadbreak connectors.

The Chardon Deadbreak Straight meets all the requirements of HD629.1 , EN-50180 , EN-50181 & IEC 60502, and is fully interchangeable with competitor's products and mating products that meet EN-50180 & EN-50181

Chardon Deadbreak Straight Connectors are molded using high quality peroxide –cured insulating and semi-conducting EPDM rubber. All insulating rubber is compounded in house, using Chardon - developed proprietary formulations. Chardon Deadbreak Straight Connector contains a copper or bi-metal conductor contact, this ensures a reliable operating connection.

## Production Tests

Tests conducted in accordance with HD 629.1

- Minimum Corona Voltage Level – 22 kV < 3 pC
- AC 1 Minute Withstand – 60 kV
- Test Point Voltage Test

Tests conducted in accordance with Chardon manufacturing process requirements:

- Physical Inspection
- Periodic Dissection
- Periodic X-Ray analysis

## Voltage Ratings

Maximum Voltage Class (Um)	24 kV
AC 5 Minute Withstand	57 kV
Minimum Corona Voltage Level	22 kV < 3 pC
BIL and Full Wave Crest (Impulse)	125 kV

## Current Ratings

Continuous Current	250 A
Overload Current (8 hour maximum)	300 A

## Detailed composition of the Chardon Deadbreak Straight Connector

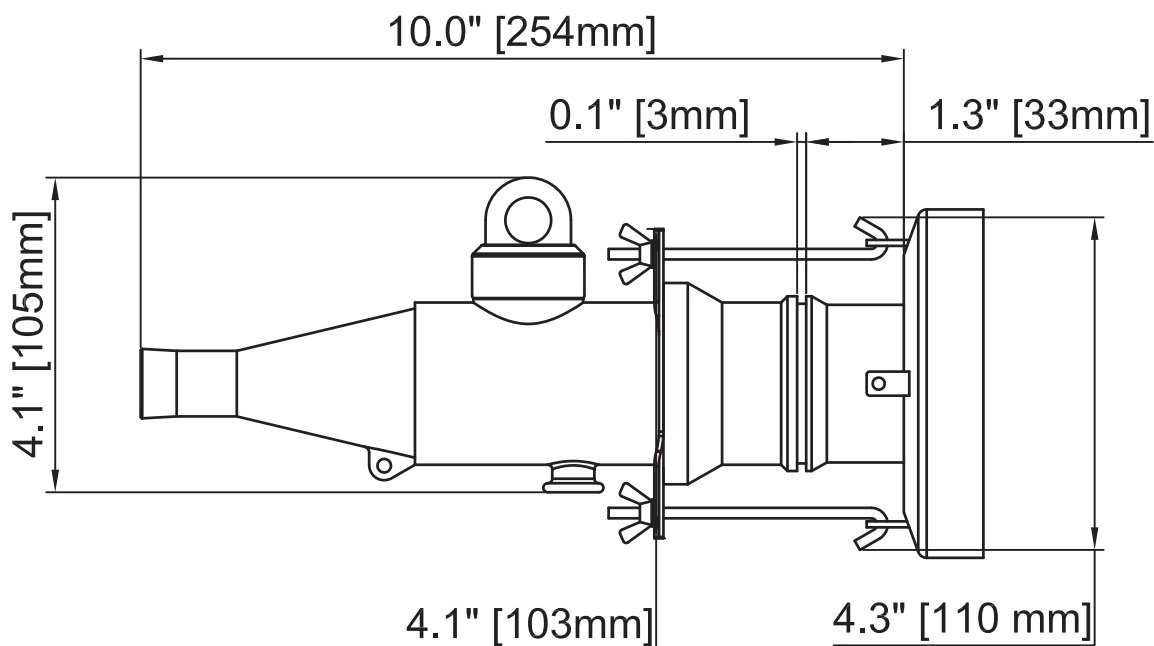
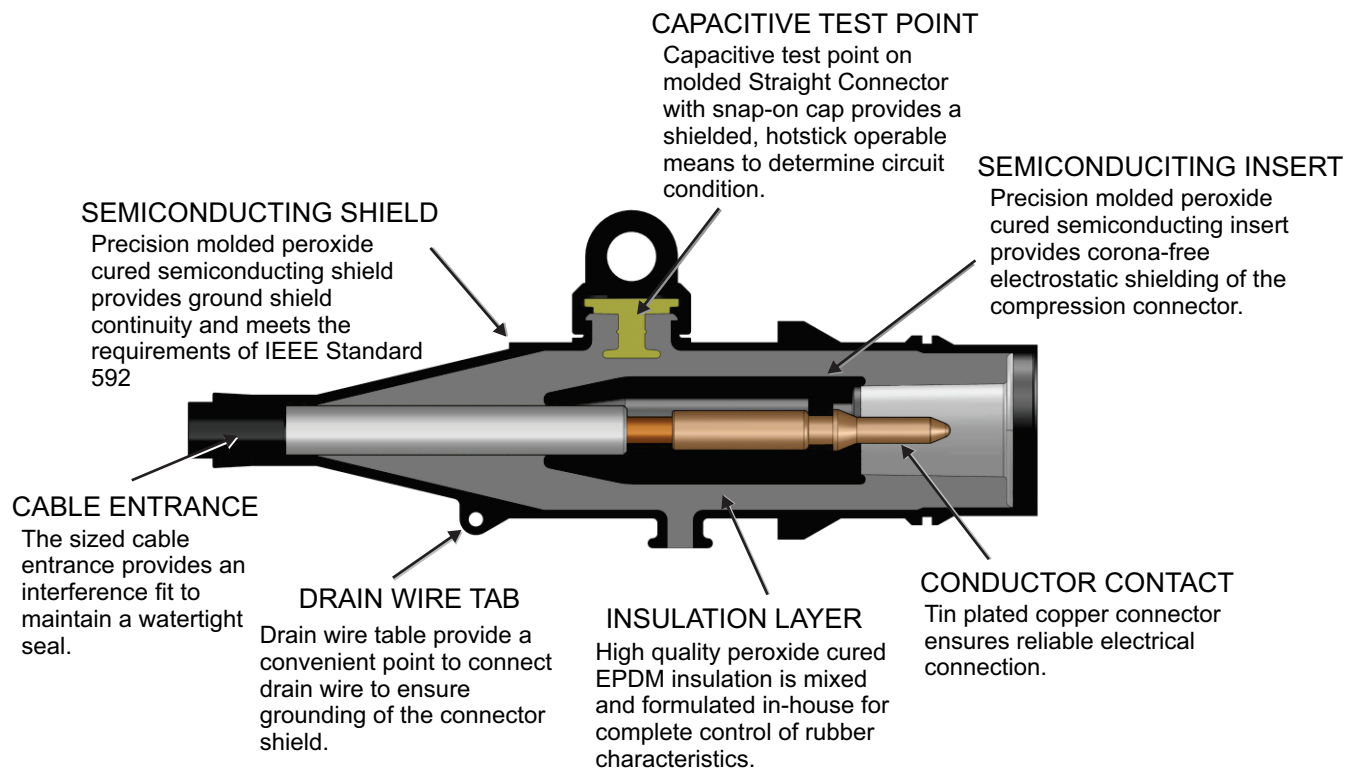

## ORDERING INFORMATION: 17.5/24kV Straight Connector

Each kit Contains

- Straight Connector body
- Bail Assembly
- Installation Instruction Sheet
- Conductor Contact
- Silicone Lubricant

To order a Chardon 24kV Deadbreak Straight Connector Kit ,  
follow the steps below :

24-CL250	W	X	Y	Z
----------	---	---	---	---

W = Enter T if want a Capacitive Test Point

X = Cable Range Code ( See Cable Range Table)

Y = Conductor Code ( See Conductor Table)

Z = Enter C if a plated Copper Connector is Desired

### Cable Range Table (Insulation Diameter)

Cable Range Code	Inches	Millimeters
A	0.642-0.807	16.3-20.5
B	0.768-0.945	19.5-24.0
C	0.906-1.106	23.0-28.1

### Conductor Code Table (Compression Connectors)

Conductor CODE	Concentric or Compressed		Compact or Solid	
	AWG or kcmil	mm2	AWG or kcmil	mm2
03	#3	25	#2	35
04	#2	35	#1	-
05	#1	-	1/0	50
06	1/0	50	2/0	70
07	2/0	70	3/0	-
08	3/0	-	4/0	95
09	4/0	95	250	120
10	250	120	300	-

Example : To order a standard Chardon 17.5/24kV Deadbreak Straight Connector with a cable insulation diameter of 0.990", a 4/0 bi-metal compression connector, and a capacitive test point, order the part number 24-CL250TC09



## **Chardon Taiwan Corporation**

No. 37 Min-Chie Road  
Tung Lo Industrial Park  
Miao Li, Taiwan 366  
Phone: 886-3-798-4385  
Fax: 886-3-798-4770

**[www.chardongroup.com](http://www.chardongroup.com) • [info@chardongroup.com](mailto:info@chardongroup.com)**